



# CastoCera Liner

FOR SEVERE IMPACT & ABRASION APPLICATION



Experts in repair and maintenance at your SERVICE  
*Pioneering Industrial Sustainability*

## Performance Mindset With CASTOLIN EUTECTIC!

Critical industrial equipment is subject to extreme wear, with planned and unplanned shutdowns increasing your maintenance and operational costs. Areas that are difficult to access, such as those at a high elevation, pose an even greater risk to employee safety and your bottom line. In this type of environment, superior wear-resistant materials are vital to covering wear-prone areas and serve as a way for companies to improve performance and reduce costs.

As a strong global player in wear management and performance, CASTOLIN EUTECTIC is committed to delivering “the optimum solution” to improve your operational and maintenance KPIs, such as:

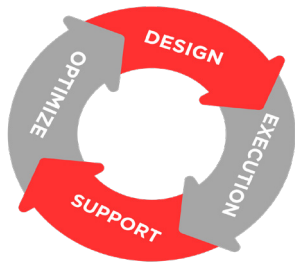

- Mean time between failures (MTBF)
- Maintenance man-hours (MMH)
- Mean downtime (MDT)
- Cost per ton mined (CPTM)

### Your bottom-line matters to us!

Our wear experts are dedicated to helping you realize the lowest cost-per-ton possible using our wear management solutions. From mobile and fixed equipment to complete backfill piping systems, our global teams offer field and benchmark performance testing and mine-specific baseline analysis to determine your total cost of ownership. Schedule a service call with one of our industry specialists today!

For over 100 years, Castolin Eutectic has been at the forefront of supplying the market with value-added surface protection products and solutions. Castolin Eutectic strives to improve the existing life cycle of plant assets to provide the optimum operational performance against the effects of high-wear abrasion, high-impact, gouging, and other wear-related maintenance failures.

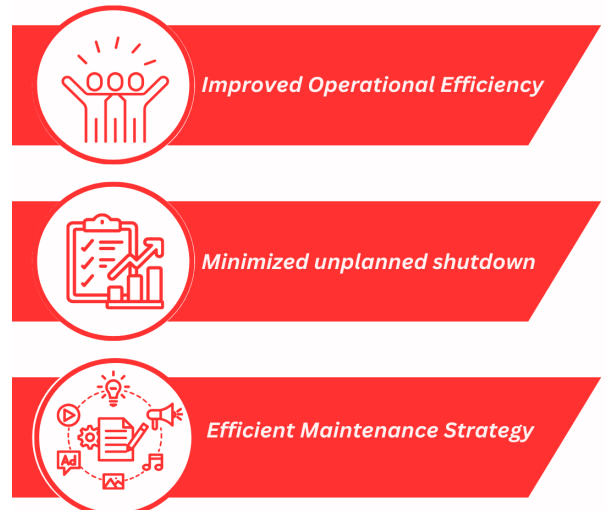

**Pioneering Industrial Sustainability**

[www.castolin.com](http://www.castolin.com)

## Global Presence & Local Outreach

Our UAE Service Centers provide a local presence, though our expertise spans the globe. with international teams that pool resources to solve difficult industrial wear problems in a cost-effective way.

## Pioneering Industrial Sustainability



Mining



Power



Steel



Cement



Agricultural



Pulp & Paper



Oil & Refinery



Heavy Machinery



1538 Employees



10 Supply Centers



20 Service Centers



31 Market Centers

Castolin Eutectic wear management specialists have technically advanced solutions that redefine equipment life cycles across service centers, regardless of the wear mechanism

# Pioneering Industrial Sustainability

[www.castolin.com](http://www.castolin.com)



### Description

Castocera is a state-of-the-art liner engineered to deliver superior wear protection for equipment subjected to high-energy impacts and abrasive materials. Designed with a unique combination of the exceptional abrasion resistance of ceramics and the strength, toughness, and malleability of eutectic alloy metal, Castocera offers unmatched durability in the most demanding industrial environments. Ideal for use in industries such as mining, cement, and power generation, Castocera's innovative composite material provides a higher impact tolerance than pure ceramic liners, making it the ultimate solution for extending the life of your critical equipment. By effectively reducing wear and minimizing maintenance, Castocera helps you optimize operational efficiency and reduce downtime, ensuring your operations run smoothly and cost-effectively.

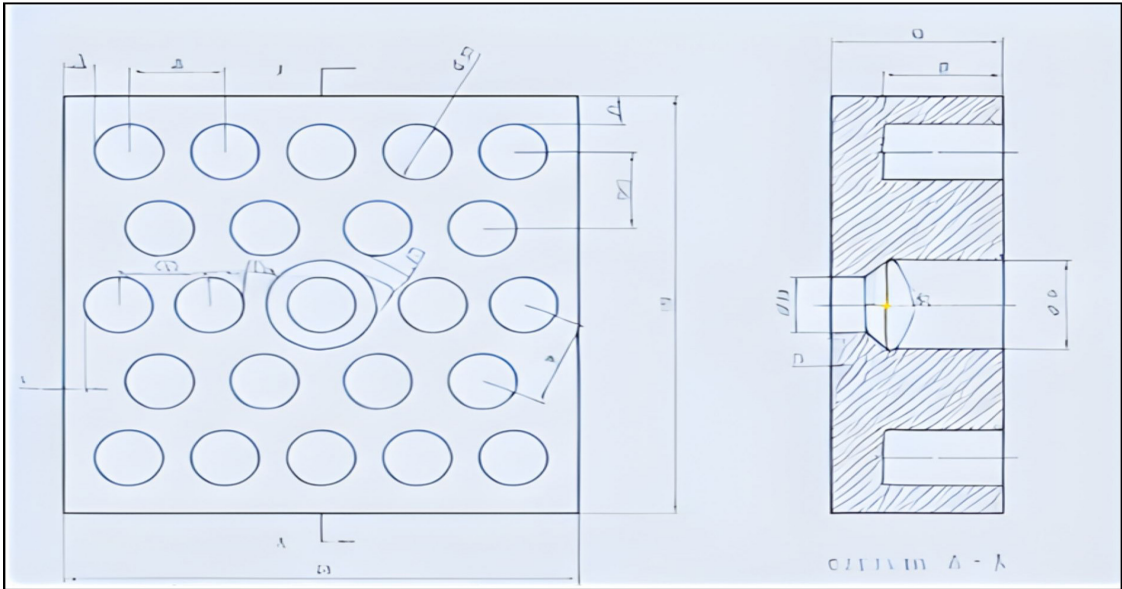



## Advantages

- Highest Impact Resistance
- Highest Abrasion Resistance
- Extended Equipment life
- Cost Efficiency
- Easy Installation and Replacement
- Reduced downtime
- Custom made size can be available

## Technical Data:

- Unique Base Metal Matrix
- Eutectic tough alloy layers
- Matrix Hardness : 600 to 650 BHN
- Elements : Eutectic Alloy Composition
- Embendation : Alumina Ceramic Cylinders
- Size Available :
  - L 150 \* W 150 mm
  - L 150 \* W 300 mm
  - L 300 \* W 300 mm
- Thickness : 30 mm & 50 mm

*Note: Manufacturing of custom size are available on special order.*

## Applications

- Transfer chute liner,
- Crusher body, inlet & outlet chutes liners.
- Belt skirt liner.
- Feed bin liners & tray liners.
- Ore chutes
- SAG mill / Ball mill Inlet hopper chutes



**Pioneering Industrial Sustainability**

[www.castolin.com](http://www.castolin.com)



## WHO WE ARE WHY WE DO, WHAT WE DO

Millions of users in the heavy-duty and wear industries trust our brand. For over 100 years, we have developed innovative products and solutions for our customers and risen to the challenge of reducing maintenance costs and increasing industrial productivity through welding, brazing and coating technologies.



Services



Welding

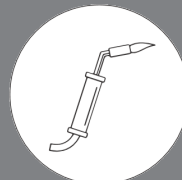

Brazing



Coating



Equipment

## CUSTOMER SATISFACTION IS THE KEY

### CUSTOMER FOCUS

- Global sales presence with sales engineers, product and key account managers
- Focus on customer needs: one face for the customer
- Partnership / long-term relationship: shared competitive advantage

### GLOBAL INFRASTRUCTURE

- Multiple manufacturing/services sites as well as warehouse and logistics capabilities in Americas, Europe, AME and Japan/Asia

### TECHNOLOGY LEADER

Broad technology range covering all wear & joining applications

- Solutions based on service expertise, quality consumables and world-class equipment
- Complete application development from product to manufacturing capabilities

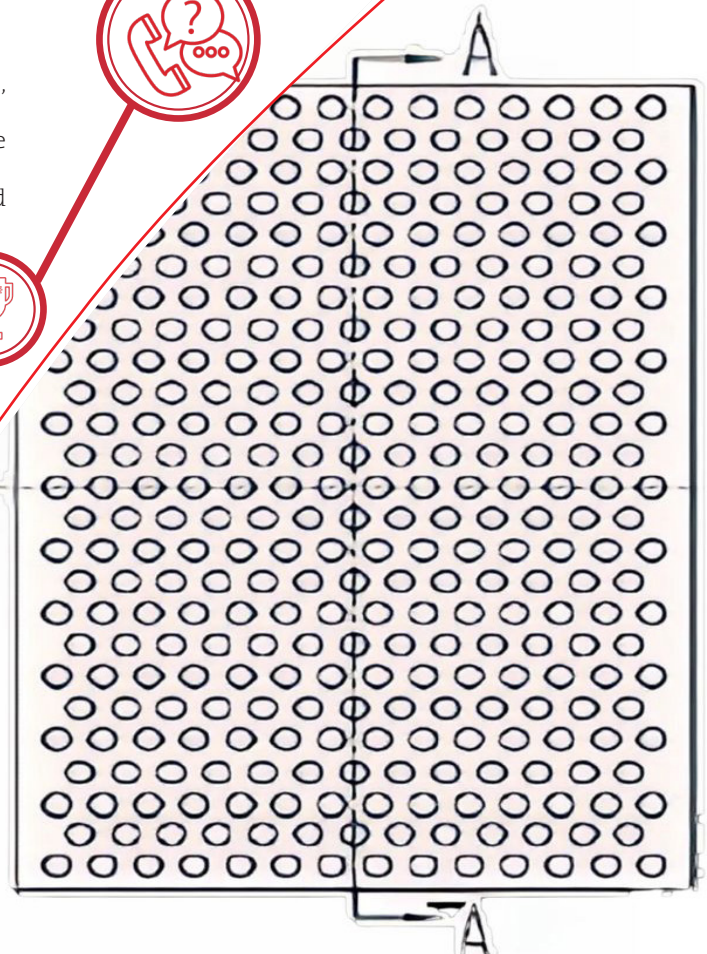

# Pioneering Industrial Sustainability

[www.castolin.com](http://www.castolin.com)

*“We help mechanical parts to perform  
beyond their limits”*



**HQ-GERMANY**

CASTOLIN EUTECTIC GMBH  
Gutenbergstraße 10, 65830  
Kriftel, Germany

Phone: +49 6192 4030  
Email: AME@castolin.com

**DUBAI -UAE**

CASTOLIN EUTECTIC ME FZE  
P.O.Box: 18656,  
Jebel Ali Freezone Extension  
Dubai, United Arab Emirates

Phone: +971 (0) 4 880 6884  
Email: AME@castolin.com

**SAUDI ARABIA**

CASTOLIN EUTECTIC SAUDI ARABIA  
Building no.7092, Prince Saad Street  
Al Khobar Al Shamliyah,  
Al Khobar-34427, Saudi Arabia

Phone: +966 13 811 4489  
Email: Cesa@castolin.com

**SINGAPORE**

CASTOLIN EUTECTIC ( SEA ) Pte Ltd  
50 Tuas Avenue 11, #01-04 Tuas Lot  
Singapore -639107

Phone: +65 6862 6008  
Email: Salesadmin.sg@eutectic.com

*Pioneering Industrial Sustainability*  
[www.castolin.com](http://www.castolin.com)